

NOTE:

- DESIGN BATTERS SHOWN HAVE BEEN CREATED INTERFACING TO A GROUND MODEL COMBINING UAV SURVEY AND LIDAR DEM
- AERIAL IMAGERY SHOWN WAS RETRIEVED FROM DATALINZ WEBSITE WHICH WAS FLOWN IN 2021
- THE COORDINATE DATUM IS IN NZTM AND THE VERTICAL IS IN NZVD 2016

LEGEND : VERTICAL GRADES

| | |
|--|-------------|
| | 0% TO 8% |
| | 8% TO 12% |
| | 12% TO 15% |
| | 15% OR MORE |

300 mm
200
100
50
0 10 mm

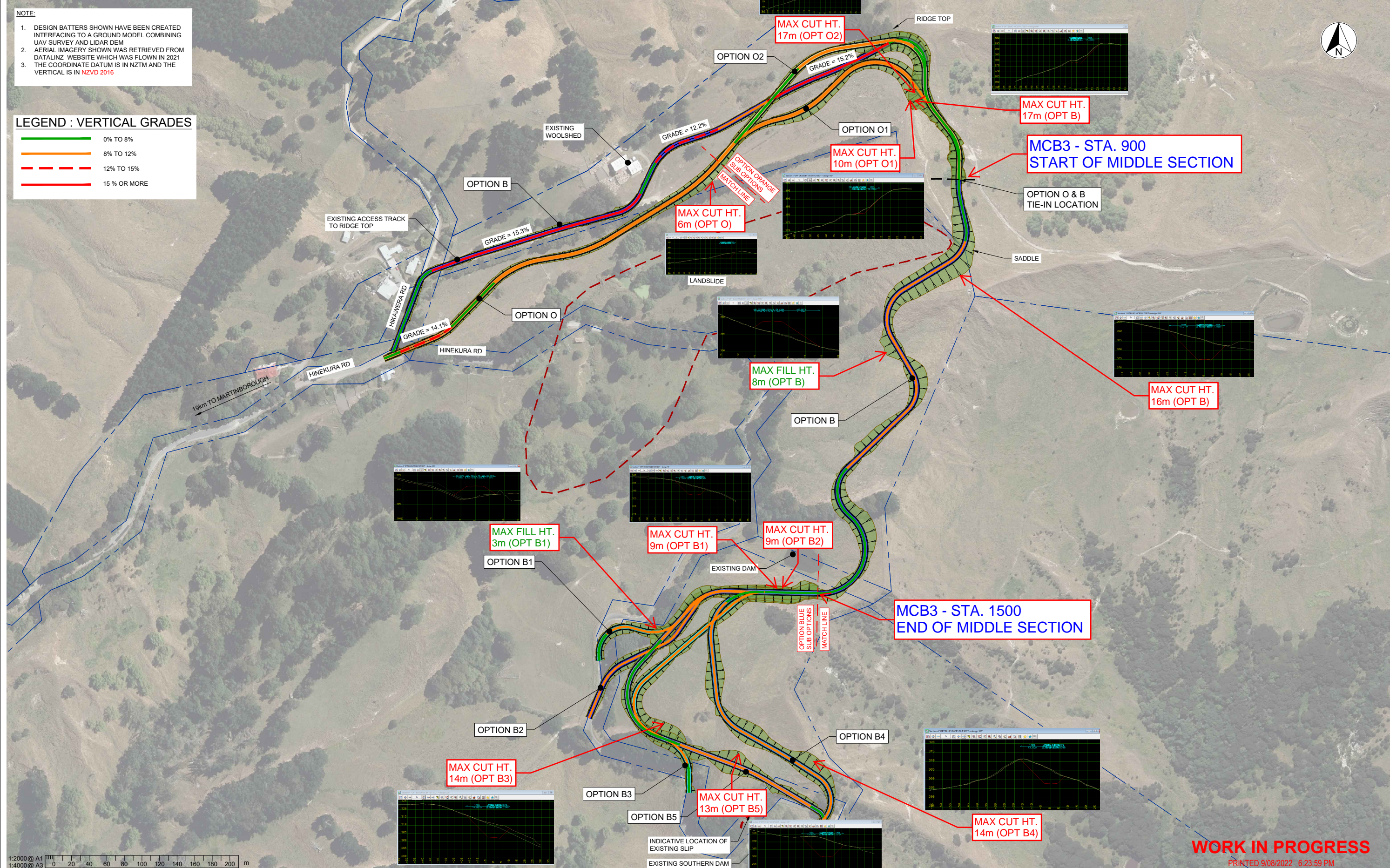

1:2000@ A1
1:4000@ A3

| REVISION | AMENDMENT | APPROVED | DATE |
|----------|----------------|----------|------|
| UR* | UNDER REVISION | | |
| | | | |
| | | | |
| | | | |
| | | | |

wsp
Wellington Office
+64 4 471 7000

PO Box 12-003
Wellington 6144
New Zealand

CIVIL

| 1:2000(A1), 1:4000(A3) | | ORIGINAL SIZE |
|------------------------|-----------------|---------------|
| DRAWN | DESIGNED | A1 |
| N.M. | N.M. | APPROVER |
| DRAWING VERIFIED | DESIGN VERIFIED | APPROVED DATE |
| VERIFIER | VERIFIER | YYYY-MM-DD |

PRELIMINARY

| | | |
|-------------------------------|----------|-----------------------------------|
| PROJECT | | CARTERTON DISTRICT COUNCIL |
| TITLE | | HINEKURA ROAD ROAD REALIGNMENT |
| TITLE | | REALIGNMENT OPTIONS OVERVIEW PLAN |
| WSP PROJECT NO. (SUB-PROJECT) | | 5-C4072.01 |
| SHEET NO. | REVISION | |
| SK00 | UR* | |

WORK IN PROGRESS
PRINTED 9/08/2022 6:23:59 PM