

SOUTH WAIRARAPA DISTRICT COUNCIL

14 DECEMBER 2011

AGENDA ITEM E1

REPORT FROM HER WORSHIP THE MAYOR

Purpose of Report

To update Council on activities and issues which have arisen since my last report to Council.

Recommendations

Her Worship the Mayor recommends that Council:

1. *Receive the information.*

1. Combined District Plan Committee

A Hearing was held on 24 November 2011 for the Bidwills Industrial Zone private plan change. The meeting was adjourned so that the officers can prepare a Decision Report.

2. Southern Wairarapa Safer Community Council

Board and Management meetings held 22 November 2011. The organisation continues to function well, on track meeting contract requirements and within its budgets.

WRS/RTC verbal update will be given as meetings post this report.

3. DHB Health Leadership Forum

Green paper for Vulnerable Children.

Feedback is being sought on this paper by 28 February 2012. The DHB is asking that as many organisations and individuals make their thoughts on this paper known and to simplify this process have produced a template for use by anybody who wishes to. If you are interested we can supply copies of the document for comment. I think it is very important that we submit as a Council.

4. Local Government Economic Leadership Course – 23 November 2011

This course was interesting although I'm not sure that it told us anything we didn't already know with regards to local government's place in economic development. It highlighted that local government contributes to ED by thinking beyond three years and providing the vision in our LTP's, ensuring our budgets support ED, advocate and support business success and support investment in the right infrastructure. Economic Development is not the same as Economic Growth. The purpose of local economic development is to develop strategies that will build the economic growth of a local and regional area. It is a process. Economic Growth is concerned with increases in the economy's output which creates greater wealth and improves well being. We can contribute to economic growth by providing places people want to live, encouraging the growth of new and innovative businesses by the way we administer and interpret legislation and having a collaborative approach to new investment. Everything we do either contributes to or inhibits economic growth. Regional and industry development is 90% driven by business with local government having only a 10% contribution.

Some interesting facts:

- Other economic recessions/stagnations have had an average cycle of 6.5 years. If this trend applies to our current position we are 2.5 years into the 6 year cycle.
- NZ is not highly rated in the world for GDP or innovation.
- NZ's manufacturing industry now represents a larger portion of our foreign earnings than the dairy industry.
- NZ is the least corrupt country in the world.
- On the world stage NZ is still relatively well off. Italy has a debt of 118 billion Euros and must save 24 billion per year to stand still; Greece 133 billion Euros and 35 billion in savings needed. France has a debt of 88.6 billion and a 3 year freeze on public spending; UK 86.9 billion and 25% cuts on budgets.

5. Civil Defence Emergency Management Group – meeting 25 November 2011

5.1 Proposal for new Emergency Management Hub.

The present Regional Emergency Management Centre is located in the GWRC building in Wellington. As well as the building itself having structural deficiencies, it is located in a reclaimed area expected to be affected by liquefaction and within the tsunami inundation zone. The proposal by Massey University to build a new Emergency Education/Management hub on campus will address both of these issues. The proposal is attached in Appendix 1.

6. Japan Study Tour

A separate report is to be tabled.

7. Mayoral Forum

A Regional Waste Minimization and Management Plan is now complete and signed off by all Councils except SWDC where it is to be presented to Councillors at the December meeting. This represents one plan for eight Councils and a huge saving for ratepayers in plan preparation and administration. It is the first combined regional plan in the country.

8. Regional Amenities Fund

All Councils have agreed to include it in their LTPs for public consultation.

8.1 Chair

Mayor Wayne Guppy has been re-elected Chair of the Mayoral Forum for a further year with Mayor Jenny Rowan as deputy. The Mayoral Forum continues to function very positively and is working well.

9. Wairarapa Moana

A report is attached in Appendix 2.

10. Correspondence

A letter from Tanya Cowen and Shawn Brown is attached in Appendix 3. They seek a lowering of the speed limit outside Martinborough School. I recommend that the matter be referred to council officers for investigation and report back to Council's February meeting on the recommended action(s).

Other Correspondence already circulated:

- Mayor's Taskforce for Jobs
- Te Papa
- Destination Wairarapa
- NZ Police Association
- Lion Foundation
- Trails Wairarapa Trust (cc'd to me)

11. Other Representation and Meetings Attended

November	Meeting/Engagement	December	Meeting/Engagement
03/11/11	Aorangi Forest Trust Event	01/12/11	LG stakeholders function
03/11/11	Citizenship Ceremony	02/12/11	LGNZ
04/11/11	Staff farewell	02/12/11	St John Awards Dinner
04/11/11	Life Flight Trust Gov House	03/12/11	Arbour House Xmas BBQ
6-17/11	Japan Study Tour	04/12/11	Wharekaka Xmas BBQ
21/11/11	DBH Health Leadership Forum	05/12/11	REAP meeting
21/11/11	Featherston Sculpture Meeting	05/12/11	Wairarapa Water Use
21/11/11	Martinborough Community Board	07/12/11	RTC
22/11/11	SWSCC	07/12/11	WRS
22/11/11	Shared Services Meeting	07/12/11	Carterton Xmas Function
22/11/11	Featherston Community Board	08/12/11	Kuranui College Junior PG
23/11/11	LG Economic Knowhow Course	08/12/11	Maori Sports Awards
24/11/11	Combined Plan Hearing	09/12/11	DBH Working Group
24/11/11	Host Belgian Tour Group	10/12/11	Featherston Xmas Parade
24/11/11	Town Hall Meeting	11/12/11	Featherston Swimming Pool blessing
25/11/11	CDEM	13/12/11	SWSC
25/11/11	Mayoral Forum	13/12/11	Solway Park function
27/11/11	Over 70's lunch		
28/11/11	Wairarapa Moana		
28/11/11	Maori Standing Committee		

12. Appendices

Appendix 1 – Massey University Emergency Management Hub

Appendix 2 – Wairarapa Moana

Appendix 3 – Letter from Tanya Cowen and Shawn Brown

Prepared By: Her Worship the Mayor, Adrienne Staples

Appendix 1 – Massey University Emergency Management Hub

Emergency Management Hub



MASSEY UNIVERSITY

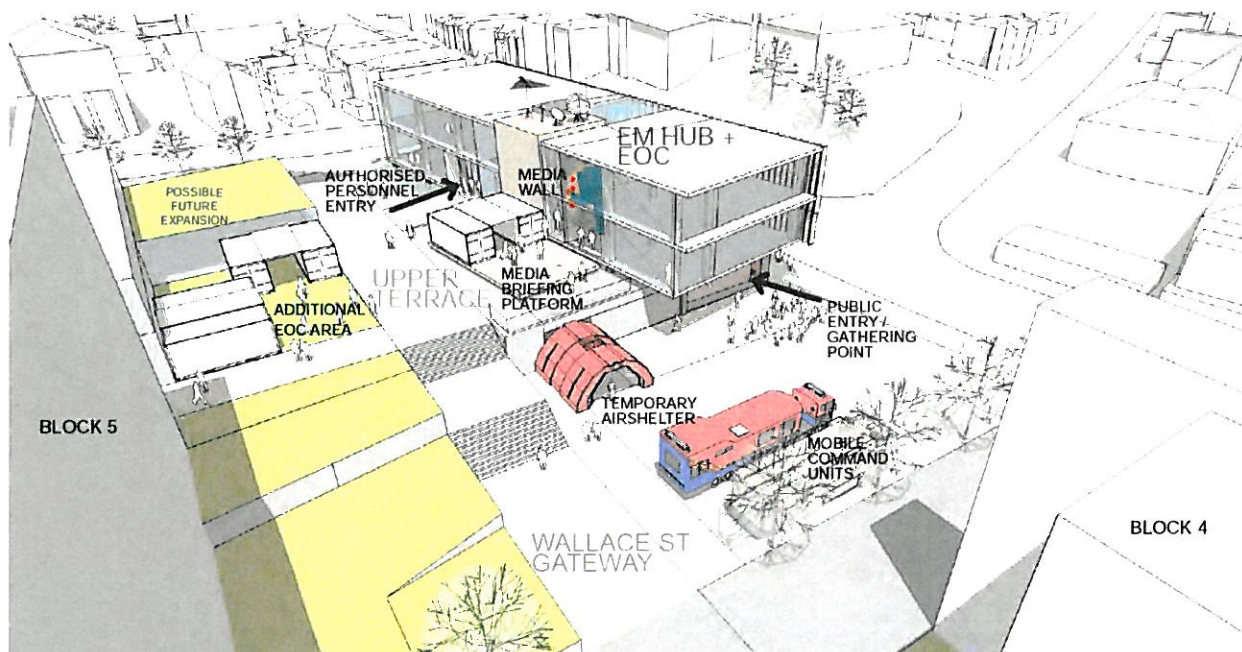

About the Emergency Management Hub

In continuing Massey University's 20 year tradition of leading emergency management teaching and research in New Zealand, the Emergency Management Hub will create a complex that co-locates strategic partners (both operational and academic) to create greater collaboration, closer industry connections and generate economic opportunities for the region. The Hub primarily to host the GNS Science/Massey University Joint Centre for Disaster Research (JCDR) and the Wellington Region Emergency Management Office. This will create natural space for students, academics and practitioners to interact. During a major disaster, campus facilities and university staff provide immediate surge capacity.

Key Specifications

- Constructed to the highest seismic construction standard (IL4) with full base isolation
- Situated outside all CBD Tsunami inundation zones (red, orange and yellow)
- Independent power (generator and solar), water, satellite internet and sewage systems
- Large 2,000m² floor area with surge capacity to remainder of campus (60,000m²)
- Environmentally sustainable design
- Decontamination portal to exterior for HAZMAT and volcanic ash events
- Highly secure complex to enable research projects under DHS Science & Technology Agreement
- Future proof staged plan concept to allow for future expansion if required
- Separate seminar room for teaching and public education, with good public transport access
- Approximate cost to build \$14-16m.

Key Benefits

- An iconic world class disaster resilient structure that improves citizens confidence in civil defence
- Creation of economic activities through international teaching, seminars, conferences and research
- Natural cross-pollination of ideas and practice across academics and practitioners
- Cost savings through shared services and facilities, such as administration and reception
- Closer ties across EMHub partners to encourage collaboration on large scale contracts and tenders
- Long term leases eliminating need for expensive capital projects by non-Massey partners
- Creation of internships for local emergency management projects—adding significant value to all
- Hosting of allied partners to create even greater collaboration and economic opportunities.

The EMHub: Bringing emergency management to
the coolest little capital in the world.

disasters.massey.ac.nz

Appendix 2 – Wairarapa Moana

Report to Wairarapa Moana Wetlands Group
Report No. 11.26
Date 14 November 2011
File CMG/01/05/01
Author Ian Gunn, Project Co-ordinator

Project Co-ordinator's update report

1. Purpose

To update the Wairarapa Moana Wetlands Group on activities within the Wairarapa Moana Wetlands Project (WMWP).

2. Recommendations

That the Wairarapa Moana Wetlands Group:

- 1. Receives the report.*
- 2. Notes the content of the report.*

3. Discussion

This is an update on the activities completed since the last meeting in May 2011.

4. Comment

4.1 Resource consent applications

Sandy Bidwell has applied to take 80 litres per second from Lake Wairarapa for irrigation purposes in the vicinity of the Mangatete Stream, on the eastern lakeshore. No news on the granting or otherwise of this consent.

A request has been received to discuss the Barrage Gates consent operation on 23 November 2011. A specific issue is the operation of the fish passage condition when Lake Onoke is blocked.

4.2 Work programme

- Recreation – a scoping study of Lake Domain by a local landscape architect is almost complete. Once it is prepared consultation will occur with interested parties.
- Marketing – Three road signs in place. Cr Fran Wilde's billboard progress is unknown. Jim to update us on the logo competition.

- Biodiversity - Work at the Ed Handyside and Mike McCreary properties at the old Ruamahanga River cutoff continued.

A significant length of the cut off has been planted on the southern bank. Clearing of exotics has commenced on the northern bank revealing a number of native species have been established.

Regular bird surveying is ongoing.

- Barrage gates painting. During the period that the gates were open in mid February to late March - a number of small research projects were completed. Powerpoint presentations on the water balance and fish studies, along with data from the bird surveys and the turf survey were presented to a combined staff group including iwi, Fish & Game staff.
- At the same meeting Martha Trodahl gave a presentation on her thesis.
- Ramsar status inquiries have been made with Hugh Robertson based in Christchurch. The document is 80% completed. Further input from the Department of Conservation is awaited.
- FENZ – this is a module which assesses freshwater ecosystems of New Zealand. This has highlighted the importance of the rivers and streams in the vicinity of Lake Onoke as a native fish habitat.
- Publicity - the Wairarapa Moana exhibition closed in May. A number of staff are contributing to a book based on the Aratoi exhibition.
- Successful planting days have been held at Lake Reserve, the Ruamahanga Cutoff – Handyside/McCreary and Ducks Unlimited at Wairio. Ducks Unlimited are using a student from Victoria University to assess establishment methodologies for native plants on the eastern lakeshore.
- The works programme budget was fully committed within the financial year. A decision was made to purchase a side-looking Doppler current meter. This will be installed upstream of the Barrage gates. It will be used to measure the actual inflows and outflows from Wairarapa Moana.
- The proposal to further the concept of hydrological replenishment of Wairarapa Moana is being pursued. Discussions have commenced with the Flood Protection and Environmental Investigations departments of GW to optimise any hydraulic modelling requirements. The Environmental Investigations Department are keen to refine a water balance for Wairarapa Moana.

4.3 Summary of conclusions from the various studies

- Martha Trodahl's thesis on Late Holocene Sediment deposition in Lake Wairarapa. The conclusions highlight that the rate of reduction of the surface area of Wairarapa Moana was "stable" from 6000 years Before Present to 1975. Between 1975 and 1996 the rate of reduction of the surface area increased dramatically, by some 16 times. This coincides with the diversion of the Ruamahanga River out of Wairarapa Moana and the construction of the barrage gates. Since 1996 the rate of reduction has

returned to the “natural rates” measured previously. This suggests that the water body has possibly stabilised following the development of the Lower Wairarapa Valley Development Scheme infrastructure.

The volume of the moana is only slightly smaller for the period 1975-2010. The bed of the moana has deepened in the south west and shallowed in the north east in the vicinity of the Tauherenikau delta.

Two core samples collected from the bed of the moana show a sedimentation rate of approximately 1 millimetre per year. The lake core samples showed strong evidence of an initial human deforestation event around 1389AD. This date supports recent published evidence for the timing of human arrival in New Zealand.

Martha believed that these studies should continue into the future along with further studies on the sediment budget, intra-lake currents and sediment movement and further sampling to investigate past catchment responses to events.

- Water balance studies for the period 16-28 February 2011 have confirmed that the summer inflow to Wairarapa Moana is the order of 2 cubic metres per second (2000 litres per second). The Wairarapa Moana lake levels observed were at the low range of lake levels. Over this period more water flowed out of Wairarapa Moana even though the lake levels were similar at the beginning and end of the period of observation. The largest impact on the lake levels is evapotranspiration, almost six times that taken for irrigation. The consented volume of water taken is similar to the input of surface water inflows. Draft estimates suggest that the inflow of groundwater to the moana is four times greater than the surface water inflows. Ongoing measurements will occur in the vicinity of the Lake Domain from a series of spearpoints installed in this area to understand the inter-connection between the shallow groundwater table and the moana lake levels. Overall because the opening blocked at Lake Onoke the Wairarapa Moana level ended up higher in March than late January.
- Wairio turf species were monitored as it was expected that flowering would occur due to the expected low lake levels. As is stated above this did not occur so no flowering was observed. These turf species are threatened with Wairarapa Moana being one of the few sites where they are still observed. Tony Silbery from DoC is now wondering if the flowering of these turf species may occur at decadal intervals.
- Fish species were surveyed upstream and downstream of the gates while the gates were open over two nights. There were less fish caught on the second night. Long fin and short tuna were caught upstream and downstream of the gates with the largest usually being netted upstream of the gates. Yellow belly flounder, yellow eyed mullet, common bully and smelt were netted downstream of the gates while perch, trout, kawahi (one large one) smelt and goldfish were netted upstream of the gates. Fresh whitebait, bullies and freshwater shrimp were observed in numbers. More sampling will be required to understand fish movement around the barrage gates.

4.3 Work Programme for the next three months

Over the next three months it is expected that the side-looking Doppler meter will be installed upstream of the barrage gates, fish survey design details will be finalised, ongoing control of alders on the eastern lakeshore, work will commence on Jury Island rehabilitation experiment, further input to the Ramsar application, bird survey work will continue, improvements to Western Lake Reserve will commence, the scoping study for Lake Domain will be progressed and further work to determine “standards” etc for the new resource management plan will continue.

4.4 Meetings attended

Separate meetings were held in July with the Farmers Group and the Wairarapa Moana Coordinating Committee at the Kahutara Hall. Last year’s work programme, the results from the investigations while the barrage gates were painted, Martha Trodahl’s thesis and the proposed works programme for this financial year were presented and discussed.

The most important item on the agenda was the formalisation of the Wairarapa Moana Coordinating Committee. Both meetings endorsed the formalisation of the Coordinating Committee. The Farmers group were keen to have 3-4 members on the committee. It was agreed that a letter would be written to all the key stakeholders previously outlined asking them to identify their representative and their alternate. It was expected there would be three meetings a year. Some members were interested in how submissions to the Wairarapa Moana Wetlands Group would be dealt with and didn’t want the Wairarapa Moana Management Team to “doctor” their submissions. This can be handled easily by officers commenting on any submissions from the Coordinating Committee.

The Farmers Group are keen to discuss the opening of Lake Onoke and the operation of the barrage gates with the Flood Protection team. I believe a meeting has been arranged. Other matters raised included the control of hornwort and the potential impacts from alder debris.

Regarding the hornwort, it was agreed that a staff member from the pest plants section will make a presentation at the next meeting.

This financial year eastern lakeshore farmers have the opportunity to apply for isolated works grants to “protect and maintain their stopbanks”. This fund provides a 30% grant, up to \$35,000 per year, to assist these farmers to protect and maintain the stopbanks they have constructed from such things as flood debris. As the river schemes know it’s critical that once a stopbank has been constructed that it be protected and maintained. This has not been a common practise on the eastern lakeshore. This fund does enable landowners with stopbanks to protect them from all forms of debris and wave lap erosion.

I attended a recent meeting with Ducks Unlimited. They continue to make good progress and have identified three groups who contribute funds on a regular basis to their ongoing development programme. They are very keen to work with Wairarapa Moana.

Report prepared by:

A handwritten signature in black ink, appearing to be 'I. Gunn', written over a horizontal line.

Ian Gunn
Project Co-ordinator

**Appendix 3 – Letter from
Tanya Cowen and Shawn
Brown**

Shawn Brown & Tanya Cowen
8 Kansas St
Martinborough
2/11/2011



To Adrienne Staples,
Mayor,
SWDC

A recent incident involving our daughter & a large truck has highlighted the danger of having the heavy traffic bypass route on the same street as the main entrance to Martinborough Primary School.

On the day this occurred, I approached the school & they agreed to better position the teacher who oversees the children on road patrol. I was also told that they fully support any assistance with improving the safety of our children.

As we appreciate that it will take time to alter the bypass, we propose that the following improvements could be made to the current route.

- *introduce a school zone speed limit. Perhaps just Monday to Friday, during the high risk morning & afternoon periods.
- *improve the signage
- *speed bumps to slow down the traffic (as in Kitchener Street)
- *compulsory stop at the pedestrian crossing - for all vehicles or perhaps just for heavy traffic vehicles.

Excerpts from the NZ Police Website

"Road crashes are a leading cause of death and injury to children between the ages of 0-14 years.

- *In 2007, 27 children aged 0-14 years were killed on the road. Of these 15 were passengers, seven were pedestrians, two were cyclists, two were drivers, and one was a motorcycle pillion passenger.*
- *In 2007, 1005 children aged 0-14 year were injured on the road. Of these 18 were drivers, 586 were passengers, 201 were pedestrians, 167 were cyclists, 13 were motorcycle drivers, 14 were motorcycle pillion passengers and six were "other" road users."*

*"Children need assistance to keep safe on or near the road."
..." they do not have the maturity or experience to judge such things as the speed at which a car is travelling."*

"Speed kills kids

..... "speed around schools is a major public health and road safety issue. Between 2001 and 2005, around 500 child pedestrians and cyclists were injured or killed each year during school terms.

- *Driving at 50 km/h, by the time you react to an unexpected event and apply the brakes, it will take you 41 metres to stop (nearly two cricket pitches, nearly half a football field).*
- *Driving at 50 km/h, you travel nearly 20 metres while reacting and moving your foot to the brake pedal; if a child was 20 metres from the car, you would still be travelling close to 50 km/h when you hit the child.*
- *A healthy adult struck at 50 km/h has about a 40% chance of being killed - for a child, the odds are much worse.*
- *In the urban environment, a child struck by a vehicle travelling at 60 km/hour has only a 15% chance of survival. When the impact speed is reduced to 50 km/hour, the chance of survival increases to 55%."*

We would be more than happy to meet with anyone if/as required...

Thank you

Yours truly,
Tanya Cowen & Shawn Brown

P.O. BOX 6
MARTINBOROUGH 5741

File:

Barbara Gavan

If calling ask for:

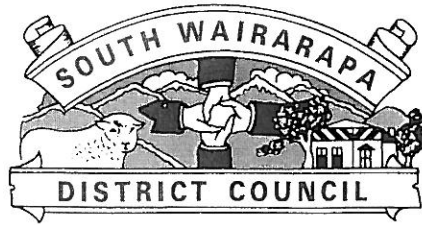

19 KITCHENER STREET
MARTINBOROUGH 5711

TELEPHONE (06) 306-9611
FACSIMILE (06) 306-9373
EMAIL enquiries@swdc.govt.nz

11 November 2011

Shawn Brown and Tanya Cohen
8 Kansas Street
Martinborough

Dear Shawn and Tanya

I am writing to acknowledge your letter of 2 November to the Mayor Adrienne Staples regarding the traffic issues in Dublin Street. In particular you raise your concerns about the danger of having a heavy traffic bypass route sharing the same street as the entrance to the Martinborough Primary School.

The Mayor is currently overseas but asked that in her absence I acknowledge your letter. Adrienne will on her return consider the points you have raised and will contact you once she has had the opportunity to discuss with the relevant agencies the interim measures you have suggested might be implemented.

Yours sincerely

Barbara Gavan
Personal Assistant

E-mail – barbara.gavan@swdc.govt.nz