

# Looking South

July 2016



## A Message from the Mayor

Local Government elections take place in October and I am stepping down as the district's mayor.

This is a position I have held for nearly 12 years and I am very proud of the Council's achievements through this time. In particular, our plan to remove all treated wastewater from our waterways and on to land, is a project that will have far reaching positive effects for our environment.

Work on this vision first started in 2008 with a commitment from Council to clean up our waterways. Projects of this nature take time and considerable investment so it is very satisfying to now be well on our way to achieving this goal for all three towns in our district.

SWDC is also in a very sound financial position. This is a very different situation to 12 years ago when damage from two very large floods had put strain on our resources. A restructure saw a new financial manager appointed. Subsequent strict budgeting and financial controls mean that we now have strong reserves and modest borrowing. That is a good position to be in.

The coming election will deliver at least six new councillors and a new Mayor to govern the district. I wish them all the best as they steer our district on what we hope will be a happy and prosperous future.

Adrienne Staples

The Mayor



## Greytown Soaring Centre:

The Greytown Soaring Centre (GSC) recently hosted world-class UK flying instructors Simon Adler and Sky Launch winch builder and instructor Mike Groves in an intense training programme for GSC pilots and winch operators.



During the training programme 140 winch operated launches were undertaken. The Sky Launch was purpose built for the GSC and is the only one of its kind in New Zealand.

Sky Launch builder and instructor, Mike Groves has built over 140 of the winches for clients around the world and is passionate about the difference winches make to gliding.

"The benefits of the winch are three fold. First they reduce the amount of noise in the environment significantly by removing the need for a tow plane to be up in the air at the same time as the glider. The cost to launch gliders is significantly reduced as well because of the reduction of fuel used. The Sky Launch pretty much halves the cost compared to a tow plane." The land that the GSC occupies is leased to them by the South Wairarapa District Council (SWDC). In 2015 SWDC granted GSC a 35 year lease to occupy the 2.5ha of land at the Papawai Airstrip and a license to occupy the grass runways east of Greytown.

South Wairarapa District Council was 100% committed to ensuring that a gliding operation was retained and enhanced in the district. This is a first-class facility and a highly valuable amenity. Already since GSC has been in operation their membership has climbed steadily, with one new member signing up on average every week.





## Waihinga Centre Update

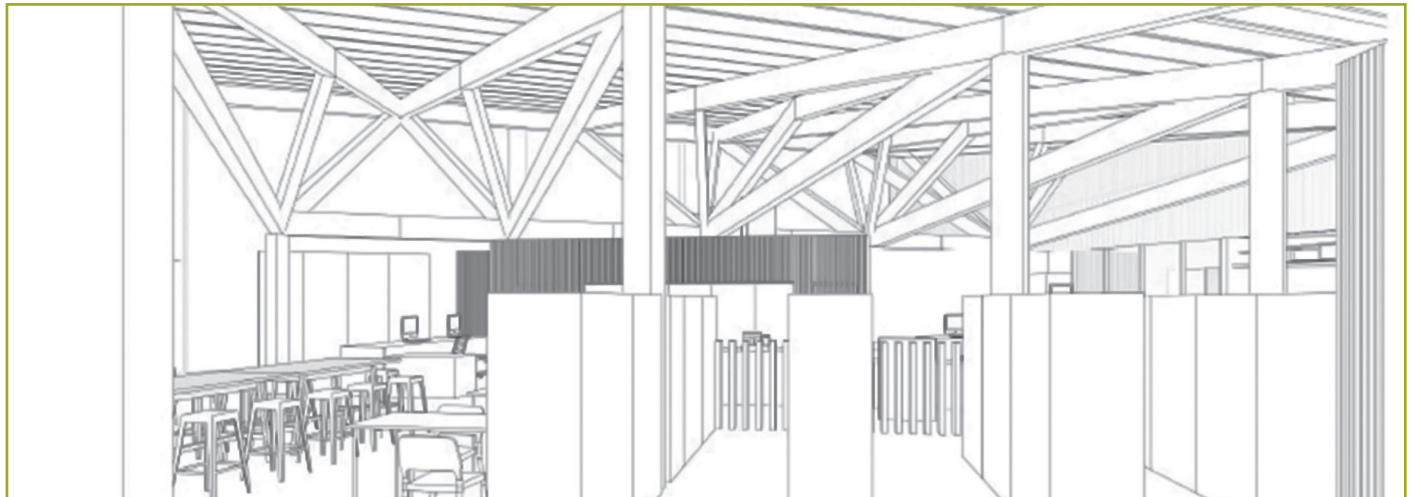

South Wairarapa District Council (SWDC) has appointed Rigg Zschokke as the preferred contractor for the Waihinga Centre in Martinborough.

The tender process Council and Quantity Surveyors Rawlinson's went through was robust and while results were close, and the tenderers were very capable of undertaking this project, the appointed contractor, Rigg Zschokke, was clearly ahead of the other RFI's received.

The critical factor was that Riggs better demonstrated their experience in the Early Contractor Involvement (ECI) process, this process is critical to the success of the project and demonstrated experience was essential.

The ECI process revolves around identifying and selecting contractors at an early stage based on 'schedule of rates' pricing.

The preferred contractor works closely with the Architects and suppliers to achieve a collaborative outcome, as compared to the traditional 'price and build on the final plans drawn' methodology.

In July and August detailed plans will be completed, consenting and final pricing undertaken and a fixed price contract signed. Building of the Waihinga Centre is expected to begin in September 2016 and be complete by September 2017.

Rigg Zschokke are a Wairarapa based commercial and residential construction company established in 1934.

Some of their projects include the Masterton Hospital Redevelopment, JNL Plywood Mill and Wharekauhau Country Estate projects.

## Advertising in Public Places

Recently questions have been asked about Council's policies relating to advertising in public places (parks) and on /along roads. Council have rules to control advertising both in the District Plan and Council bylaws. The District Plan does not normally allow advertising beyond the site on which a business operates. Exceptions to this general rule do exist but Council only applies these in unusual situations or for temporary events.

For example temporary events can be advertised broadly but only for a set period prior to it taking place and in compliance with standards relating to size and traffic safety. Commercial activities like rug sale businesses are however not permitted to erect signs on Council property (except at the site of the sale) or along or about roads in the district. Council's bylaws do allow for a business to place boardwalk type signs immediately outside a business premise on the sidewalk, subject to standards such as not creating an obstruction or detracting from an amenity.

Council takes breaches of these advertising requirements very seriously and will confiscate illegal signs placed in public places and along roads. Council will also take legal action against offenders (fines or even prosecution) in addition to charging the offender for the costs incurred in removing a sign(s).

If a member of the public thinks any signs have been erected without permission, they should contact Council directly during normal working hours or on Council's after hours number at other times. The details of the complainant will be recorded by Council but these are not made public.



## Refuse and Recycling

The refuse and recycling collection is a kerbside service for Ratepayers (mainly urban) who pay a refuse collection charge in their Rates. The quantities that are considered acceptable for domestic usage are:

- ◆ 2 bags of refuse in the official yellow council bags.
- ◆ 1 recycling bin of each colour (teal and maroon) for each rateable property.

Recycling must be in the correct bin and the bin must not be overflowing.

Refuse and Recycling which is not in an official container/bag, or which is in excess of these quantities, risk not being collected.

Official Council collection rubbish bags and recycling bins can be purchased from the Council Office in Martinborough, and at our Service Centres at the Featherston and Greytown Libraries. Council bags can also be purchased from local supermarkets.

## Inorganic Collection



The next inorganic collection takes place 1- 4 August, on your allocated kerbside collection day.

Items must be out on the kerbside by 7.30am and is limited to one item per property and must be able to be lifted by one person. Typical items may include unwanted furniture and small home appliances.

Quantities exceeding this amount in the inorganic collection, risk not being collected.

## Sport NZ Rural Travel Fund 2016/17



**Funding Round Open 1 July 2016 – 19 August 2016**

**Applications are now being accepted from school and sports club teams located in the South Wairarapa district.**

SWDC has approximately \$9,000.00, provided by Sport NZ, to give to local school or sports club teams in the South Wairarapa who have young people aged between 5-19 years that require subsidies to assist with transport expenses to local sporting competitions.

Application forms, eligibility criteria and frequently asked questions can be obtained from the Council office, Council website [www.swdc.govt.nz/grants](http://www.swdc.govt.nz/grants) and South Wairarapa district libraries. If you want more information contact Suzanne Clark on 06 306 9611 or [suzanne.clark@swdc.govt.nz](mailto:suzanne.clark@swdc.govt.nz).

**Applications from school and sports clubs must be submitted at this time as there will be no further funding round for the 2016/17 year. Please note that your information may be shared between the Wairarapa councils.**

## Creative Communities Scheme



Applications for the South Wairarapa district Creative Communities Scheme (CCS) are now being accepted until 8 August 2016 for projects starting after 26 August 2016 and being completed by 26 August 2017. Approximately \$8,200.00 is available for distribution to suitable arts projects.

Before completing your application form you should carefully read the CCS brochure to see whether your project is eligible. An application guide is also available and will help you in making a great application. The brochure, application guide and application form can be obtained from the Council office, all libraries in the South Wairarapa and the Council website. If you need advice on your application contact Suzanne Clark phone **06 306 9611** or [suzanne.clark@swdc.govt.nz](mailto:suzanne.clark@swdc.govt.nz).

## Creative Communities Scheme Recipients 2015/2016

Grants were made to the following recipients in the 2015/2016 year. For more information about these projects visit our grants page <http://www.swdc.govt.nz/grants>.

Name of Applicant	Amount Allocated
Featherston Booktown	\$3,000.00
Parkinsonism Society	\$800.00
Friends of Stella and Sarah	\$1,000.00
Featherston Booktown	\$4,000.00
Yarns in Barns	\$500.00
Greytown Early Years	\$1,125.00
Greytown Music Group	\$500.00
Tangle Dance Company	\$1,000.00
Martinborough Events Trust	\$1,000.00
	<b>\$12,925.00</b>

## Calling Afterhours?

For all council enquiries in or after hours, including public holidays, please ring council on 06 306 9611. All out of hours calls will be logged and referred on for action using Councils Customer Event Management system and you will be updated of the progress of your request via SMS or email should you wish.

For all emergency services enquiries please dial 111 for Fire, Police and Ambulance.



## Rebates 2016/17

The Rates Rebate Scheme provides a rebate of up to \$610 for low income earners. Rate payers must have been living in the home they own on 1 July 2016.

- ◆ Your rebate will be calculated based on your gross income from 1 April 2015 to 31 March 2016, your rates, and the number of dependants you have. The income eligibility for a rebate is \$24,470-\$42,000.00
- ◆ You must provide proof of income from your income provider for ALL forms of income, including interest & dividends.
- ◆ Application forms will be sent to those who have received a rebate in 2015/2016 and are also available from the Featherston and Greytown Libraries, the Council office and online [www.swdc.govt.nz/rates-and-property](http://www.swdc.govt.nz/rates-and-property)

## Get Your Rates invoice by email

We now have a facility to send rates invoices by email.

If you wish to receive your rate notice by email contact [rates@swdc.govt.nz](mailto:rates@swdc.govt.nz)

We encourage you to take up this option to allow Council to use the postage savings on projects to benefit the district.

## Having Trouble Paying your Rates?

Please contact us as soon as possible so we can work with you on a payment plan.

Council's policy is to approach banks and legal representatives to assist us in recovering arrears at the end of the rating year.

## Rates 2016/17 Instalment One

Enclosed with this newsletter is the third rates assessment/invoice for the rating year, covering 1 July – 30 September 2016

**The last day for payment  
is 22 August 2016**

**Please pay by this date to  
avoid the 10% penalty.**

Please help us to process payments by ensuring you include the property (RID) number for **all** properties you are paying. If paying online please make a separate payment for each property.

## Payment by Direct Debit

For the many who have asked, we now offer both a **monthly** and a **quarterly** direct debit facility to pay rates.

Direct debit is the cheapest way to pay your rates as we withdraw the funds directly from your bank account at the very last minute. That way you will get the benefit of your funds for the longest possible time, and avoid penalties. If you would

like your payments to be made by using this method the forms are available from the Featherston and Greytown Libraries as well as the Council office and on our website [www.swdc.govt.nz/rates-and-property](http://www.swdc.govt.nz/rates-and-property). All you need to do is complete the form and send it to the Council Office, PO Box 6, Martinborough 5741 or drop it off at either the Council office in Martinborough or at the Featherston and Greytown Libraries.

## GET IT SORTED

To South Wairarapa District Council, P.O. Box 6, Martinborough 5741

From:

First Name

Surname

What's the Problem?

Where Exactly?

Street, Road, Number

Your Phone Number *(Should we need to contact you to clarify the details)*